

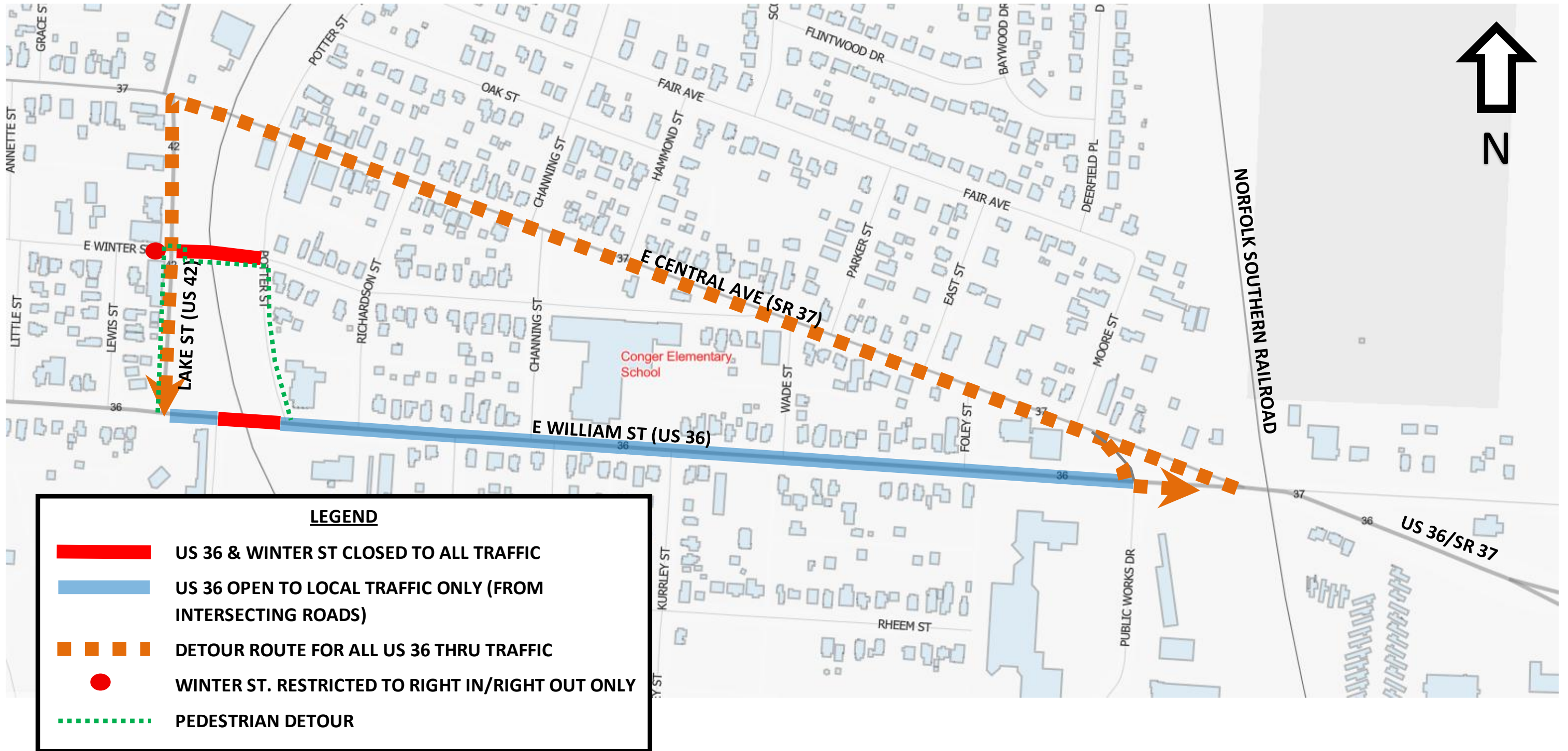

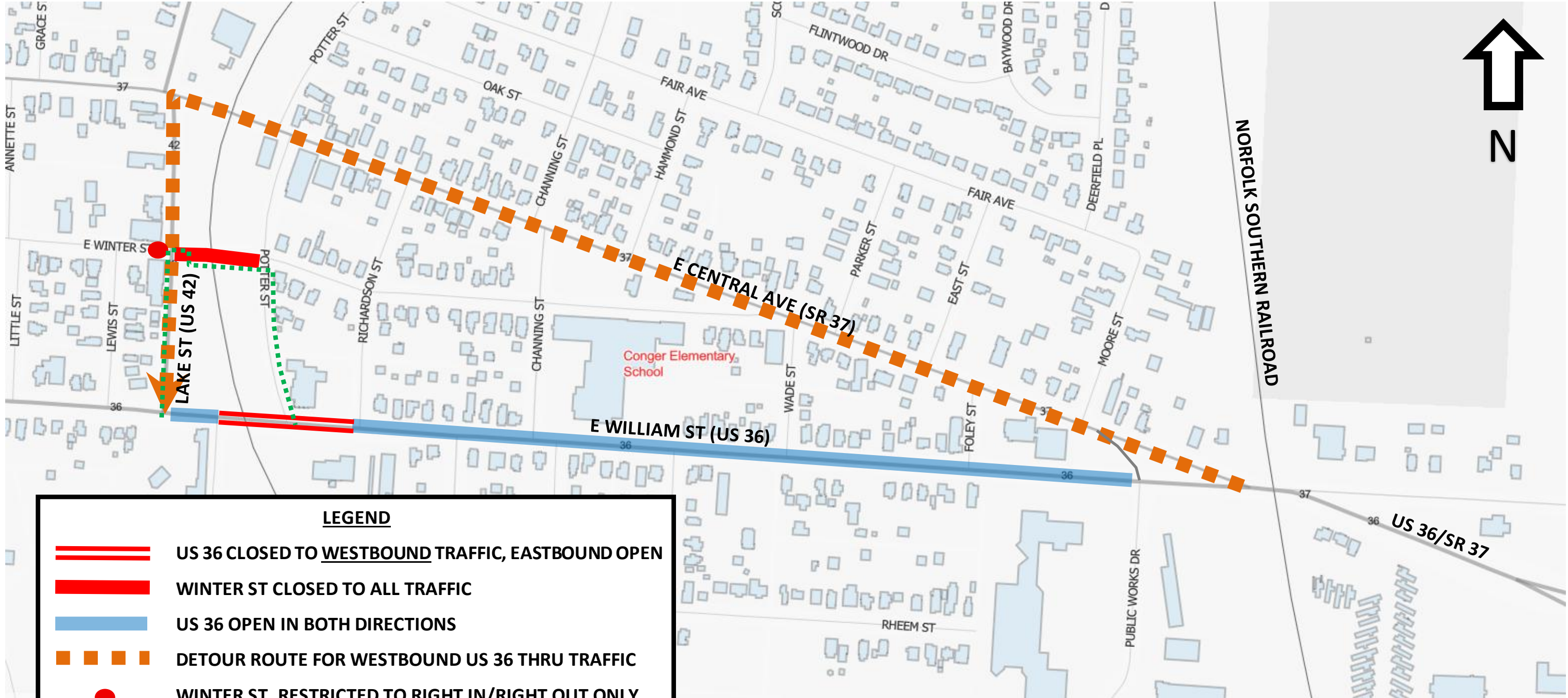

E. WILLIAM ST. DETOUR EXHIBIT – FULL CLOSURE PHASE (EASTBOUND & WESTBOUND US 36 DETOURED)



E. WILLIAM ST. DETOUR EXHIBIT – PARTIAL CLOSURE PHASE (WESTBOUND US 36 DETOURED)



LEGEND

-  US 36 CLOSED TO WESTBOUND TRAFFIC, EASTBOUND OPEN
-  WINTER ST CLOSED TO ALL TRAFFIC
-  US 36 OPEN IN BOTH DIRECTIONS
-  DETOUR ROUTE FOR WESTBOUND US 36 THRU TRAFFIC
-  WINTER ST. RESTRICTED TO RIGHT IN/RIGHT OUT ONLY
-  PEDESTRIAN DETOUR